

An opportunity to express your views on the provision of a care home on Land at Lavant Drive, Havant



Image courtesy of Google

Perseus Land and Developments Limited are consulting the community on our proposals to provide a new care home on Land at Lavant Drive, Havant.

Perseus Land and Developments are a leading developer in the development of bespoke residential accommodation for older people, including care homes.

Our plans are in draft form, and we would welcome any feedback that you may have, as we finalise our proposals and prepare to submit a planning application.

Our vision is to deliver a new and bespoke 86-bedroom care home, that will help to provide much needed accommodation for the residents of Havant, and provide opportunities for local residents to remain living locally when their care needs increase.

The Proposed Site

The site has been vacant for some time, having previously been the site of the former Oak Park Secondary School. It is allocated in the Local Plan, with the adjoining site, for a care development.



We welcome your views

We value the views of the local community and would like to know your thoughts on our proposals.

Please provide your feedback, by email or phone, ideally by Sunday 21st June.

Alternatively, please get in touch using the contact details below.

Contact: ✉ jordan@gillingsplanning.co.uk ☎ 02382 358855

What are we proposing?

It is proposed to construct an 86-bedroom care home, set across a part three, part two and a half storey building. The entrance is located to the south of the proposal with vehicular access from Lavant Drive.

We are still at the early stages of design, so are working on what the care home will look like – but the vision is to create a high quality home, using sustainable materials that fit into the local area.

Within the care home, alongside the bedrooms will be living and dining rooms, to provide a quality, homely environment for residents. The proposed accommodation will exceed Care Quality Commission standards with all residents provided with spacious, ensuite bedrooms.

Outside, the proposal includes 27 car parking spaces, 2 of which are for disabled users, and a bay for services. The proposal also includes refuse stores, cycle storage, space for air source heat pumps and extensive landscaped gardens.

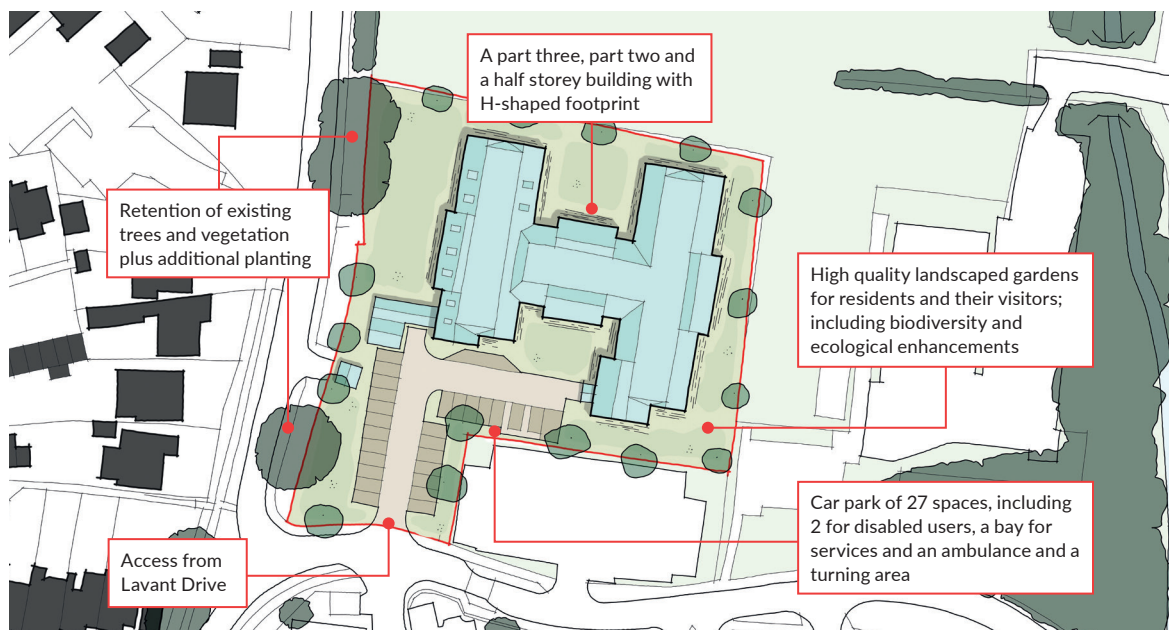

Key Benefits

The proposal will bring the following significant benefits to the local area:



The provision of much-needed and high-quality care accommodation designed specifically for the elderly, providing opportunities for local residents to remain living locally when their care needs increase and helping to free up existing homes within the local area.



Economic benefits through employment opportunities and additional spending at the construction and operational stages.



Environmental benefits through the introduction of additional landscaping which in turn will enhance biodiversity.

We welcome your thoughts and comments on the proposal

Contact: ✉ jordan@gillingsplanning.co.uk ☎ 02382 358855